

Data Sheet R7500

Series 7500/75 & 7600/76

Roller Bearing Gear Pumps, Motors and Flow Dividers

- Single or multiple units available.
- Piggy back options available.
- Displacement 33 cc/rev to 199 cc/rev.
- Gear widths 1/2" to 3".
- Minimum operating speed 400 rpm.
- Maximum continuous operating speed 2000 rpm.
- Maximum continuous operating pressure 2500 psi (172 bar).
- Drive shaft PL factor: Integral 12000, Continental 10000.
- Cast iron construction.
- Dowelled units available.

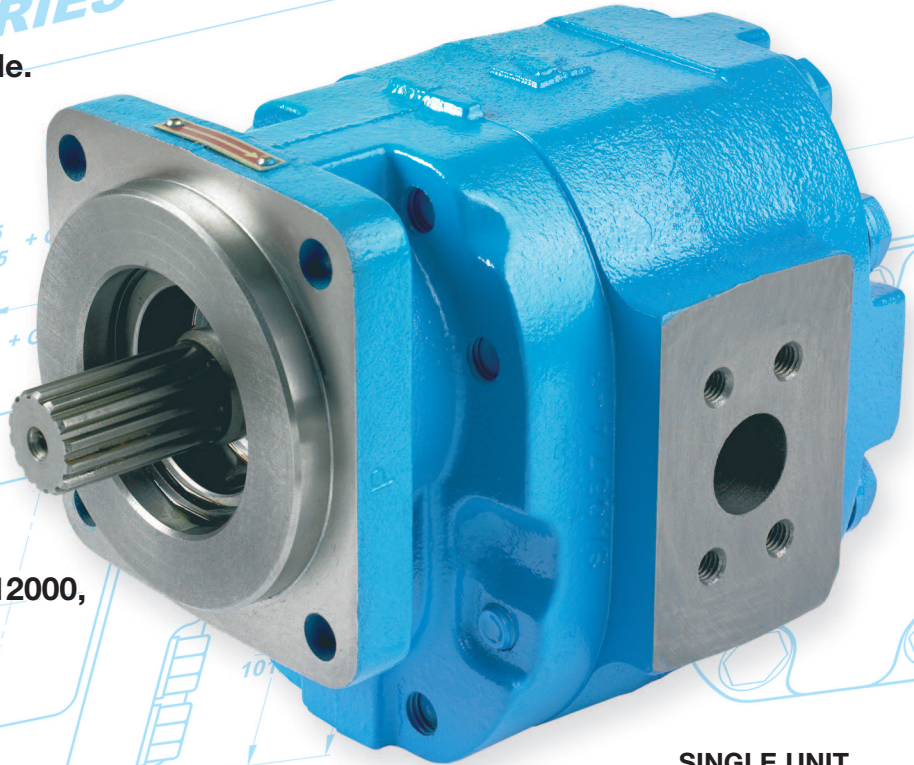

SINGLE UNIT

Mounting Flange Options:

SAE 'B' 4 bolt, SAE 'C' 2 bolt, SAE 'C' 4 bolt, SAE 'D' 4 bolt.

Drive Shaft Options:

SAE 'C' 14 tooth, SAE 'D' splined, SAE 'C' keyed.

Various Porting Options:

BSP, SAE, NPT, JIC (ODT).

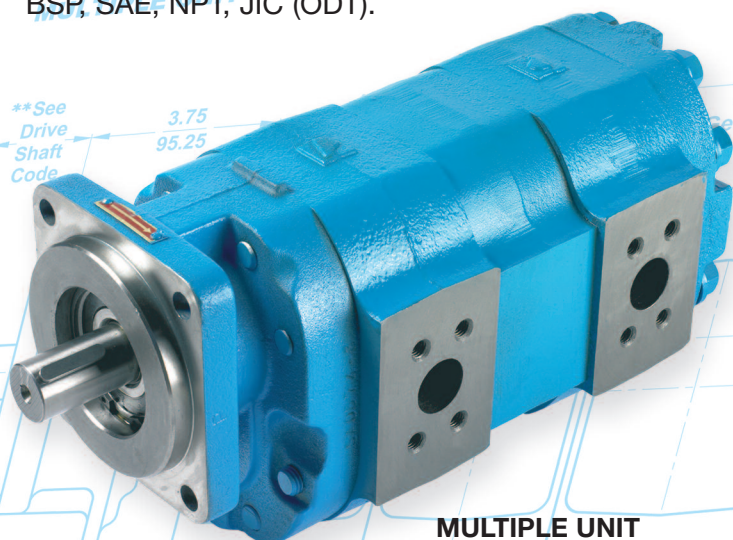

MULTIPLE UNIT

Recommended Operating Conditions:

Fluid viscosity, normal operating conditions 16 to 220 cst.

Fluid temperature should not exceed 65 deg. C.

Fluid cleanliness, 10 micron filter with Beta 200 rating is recommended.

Inlet pressure; for best operation with mineral oil, pressure should not exceed minus 0.237 bar (7 in HG).



# Series 7500 Pumps, Motors and Flow Dividers

## PERFORMANCE DATA

### Pump Performance

					Input Speed - rpm								
					1000		1500		1800				
Output- L/min/igpm – Input-Kw/Horsepower ▶					Output	Input	Output	Input	Output	Input			
Gear widths - code	Gear widths - inches	Displacement - cc/rev	Maximum continuous working pressure - bar/psi	05	1/2	33	207/3000	28 / 6.2	10 / 13	43 / 9.5	14 / 19	52 / 11.5	17 / 23
				07	3/4	50	207/3000	41 / 9.0	14 / 19	64 / 14.1	22 / 29	78 / 17.2	26 / 34
				10	1	66	207/3000	55 / 12.1	20 / 26	85 / 18.7	29 / 38	104 / 22.9	34 / 45
				12	1.1/4	83	207/3000	71 / 15.6	24 / 32	107 / 23.6	35 / 47	132 / 29.1	42 / 56
				15	1.1/2	99	180/2610	86 / 18.9	28 / 37	130 / 28.6	42 / 56	158 / 34.8	50 / 67
				17	1.3/4	116	180/2610	102 / 22.5	32 / 42	155 / 34.1	49 / 65	189 / 41.6	58 / 77
				20	2	132	180/2610	118 / 26.0	36 / 48	179 / 39.4	55 / 73	215 / 47.4	66 / 88
				22	2.1/4	149	180/2610	134 / 29.5	41 / 54	199 / 43.8	61 / 82	241 / 53.1	74 / 98
				25	2.1/2	166	180/2610	148 / 32.6	45 / 60	222 / 48.9	68 / 90	268 / 59.0	81 / 109
				27	2.3/4	182	155/2250	167 / 36.8	50 / 66	248 / 54.6	75 / 100	298 / 65.6	92 / 122
				30	3	198	155/2250	185 / 40.7	55 / 73	275 / 60.6	84 / 112	330 / 72.7	101 / 134

● Flows quoted are at test pressures of 138 bar/2000 psi, using 32cSt oil at 65 deg C.

● Performance data is derived from tests conducted to simulate working conditions. Continuous operation at maximum performance may compromise unit life.

If in doubt when specifying, please consult our sales department.

### Motor Performance

				Output Speed - rpm					
				800	1200	1600	2000		
Gear widths - code	Gear widths - inches	Input flow. Output hp & torque	10	1	Output Kw / hp	11.0 / 14.5	15.0 / 20.0	19.5 / 26.0	23.0 / 30.5
			Output Nm / in.lb	124.5 / 1100	123.0 / 1090	117.5 / 1040	109.5 / 970		
			Input l.min / igpm	72.5 / 16.0	100.0 / 22.0	127.5 / 28.0	154.5 / 34.0		
			15	1.1/2	Output Kw / hp	16.5 / 22.0	23.0 / 31.0	30.5 / 41.0	37.5 / 50.0
			Output Nm / in.lb	192.0 / 1700	190.0 / 1680	186.5 / 1650	181.5 / 1600		
			Input l.min / igpm	104.0 / 23.0	143.0 / 31.5	186.5 / 41.0	225.0 / 49.5		
			20	2	Output Kw / hp	22.0 / 29.0	32.0 / 42.5	41.5 / 55.5	51.0 / 68.0
			Output Nm / in.lb	256.5 / 2270	255.5 / 2260	251.0 / 2220	246.5 / 2180		
			Input l.min / igpm	129.5 / 28.5	184.0 / 40.5	241.0 / 53.0	295.5 / 65.0		
			25	2.1/2	Output Kw / hp	28.0 / 37.5	41.0 / 54.5	53.5 / 71.5	65.0 / 87.0
			Output Nm / in.lb	331.0 / 2930	328.0 / 2900	321.0 / 2840	312.0 / 2760		
			Input l.min / igpm	159.0 / 35.0	227.0 / 50.0	293.0 / 65.0	363.5 / 80.0		
30	3	Output Kw / hp	35.0 / 47.0	52.0 / 69.0	67.0 / 89.5	82.0 / 109.0			
Output Nm / in.lb	418.0 / 3700	416.0 / 3680	404.0 / 3570	388.0 / 3430					
Input l.min / igpm	186.0 / 41.0	272.5 / 60.0	354.5 / 78.0	434.0 / 95.5					

\* These gear widths are the popular sizes for motor configurations but any of the gear widths listed in the Pump Performance table can be supplied.

## WEIGHTS (approximate)

Gear widths (ins)	1/2	3/4	1	1.1/4	1.1/2	1.3/4	2	2.1/4	2.1/2	2.3/4	3
Single unit (kg)	30.5	32.0	33.0	34.0	35.0	36.0	37.5	39.0	40.0	41.0	42.0

For multiple unit weights, please consult our sales department.

## DIMENSIONS

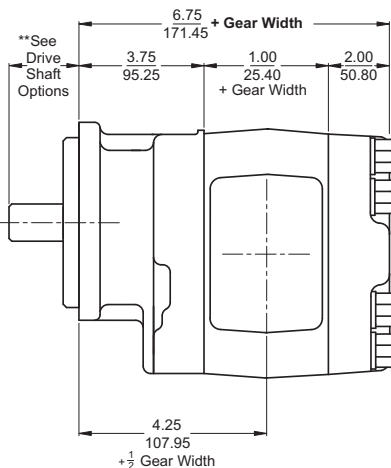

SINGLE UNIT

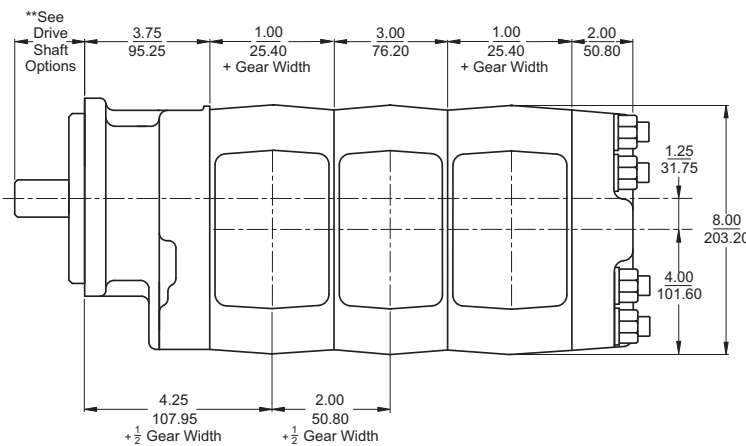

MULTIPLE UNIT

### SINGLE UNIT

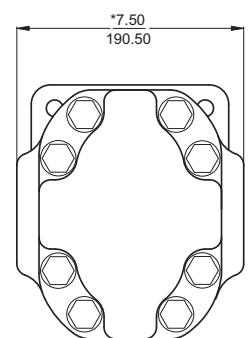

\*Standard port arrangement, dimension will change with type of port.

\*\*Dimensional information for mounting flange and shaft options are shown on the attached Data Sheet FS100.